

SOXMATIC

AUTOMATIC STEAM BOARDING AND PACKAGING LINE FOR SOCKS

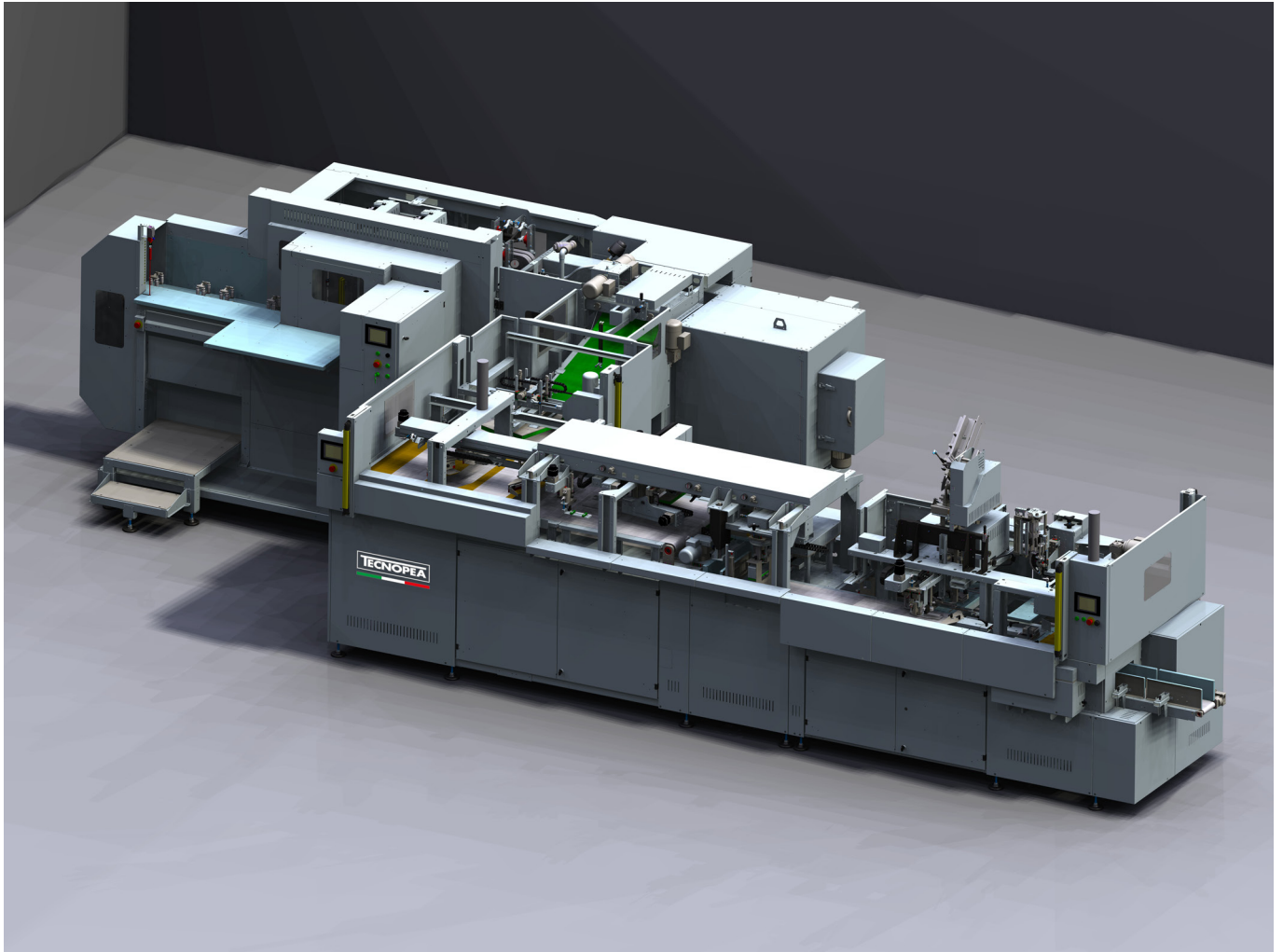

SOXMATIC AUTOMATIC STEAM BOARDING AND PACKAGING LINE FOR SOCKS

- Load assist to correctly align and place the socks on the boarding forms.
- Steam boarding machine.
- Folding device.
- Flipping system.
- Stacking device.
- Preparation for single or double stack.
- Exit belt to the next packaging module.

The line shown in the image and lay-out includes the module for the application of the cardboard rider by means of a plastic pin.

SOXMATIC

AUTOMATIC STEAM BOARDING AND PACKAGING LINE FOR SOCKS

Soxmatic is a new concept for the steam setting and handling process of socks with a very low use of labor. The system consists of two parts that can also be supplied individually:

Loader + Boarding Machine

Steam boarding machine with 28 forms, steam chamber operating at a maximum pressure of 3 bar, equipped with an automatic device for positioning the elastics. The machine is fed by a high-speed automatic loader which provides for the correct orientation of the socks, by means of digital video cameras, and for their correct loading on the boarding forms. The extreme simplicity of the system means that only one operator can feed it while maintaining the maximum operating speed.

Socks assortment + Packaging

Automatic line for pairing and preparing socks for packaging with the selection of multiple folding and stacking options. The machine is connected directly to the boarding unit from which it receives the pair of socks, measuring their length and possibly discarding those outside the set tolerance. Through the graphic display all the options relating to the rotation, flipping and stacking of each pair can be easily selected in order to make the system very flexible and to use it for any presentation of the products required. Thanks to a very fast working cycle and its great flexibility, Soxmatic is able to feed various types of packaging machines obtaining products with cardboard rider, band and/or bag.

| Specifications | Values |
|-------------------------|---------------------------|
| Dimensions | 9.583 X 4.250 x 2.290 (h) |
| Air pressure | 6 Bar |
| Air consumption | 46,5 M ³ /h |
| Installed power | 14 kW |
| Avg. absorbed power | 4 kW |
| Min steam line pressure | 6 Bar |
| Steam consumption range | 30 - 60 kg/h |

| Features |
|----------------------------|
| High productivity |
| Flexibility |
| Multiple packaging options |

SOCKS PREPARATION



SOXMATIC

AUTOMATIC STEAM BOARDING AND PACKAGING LINE FOR SOCKS

4248.5
13 FT 11 17/64 IN

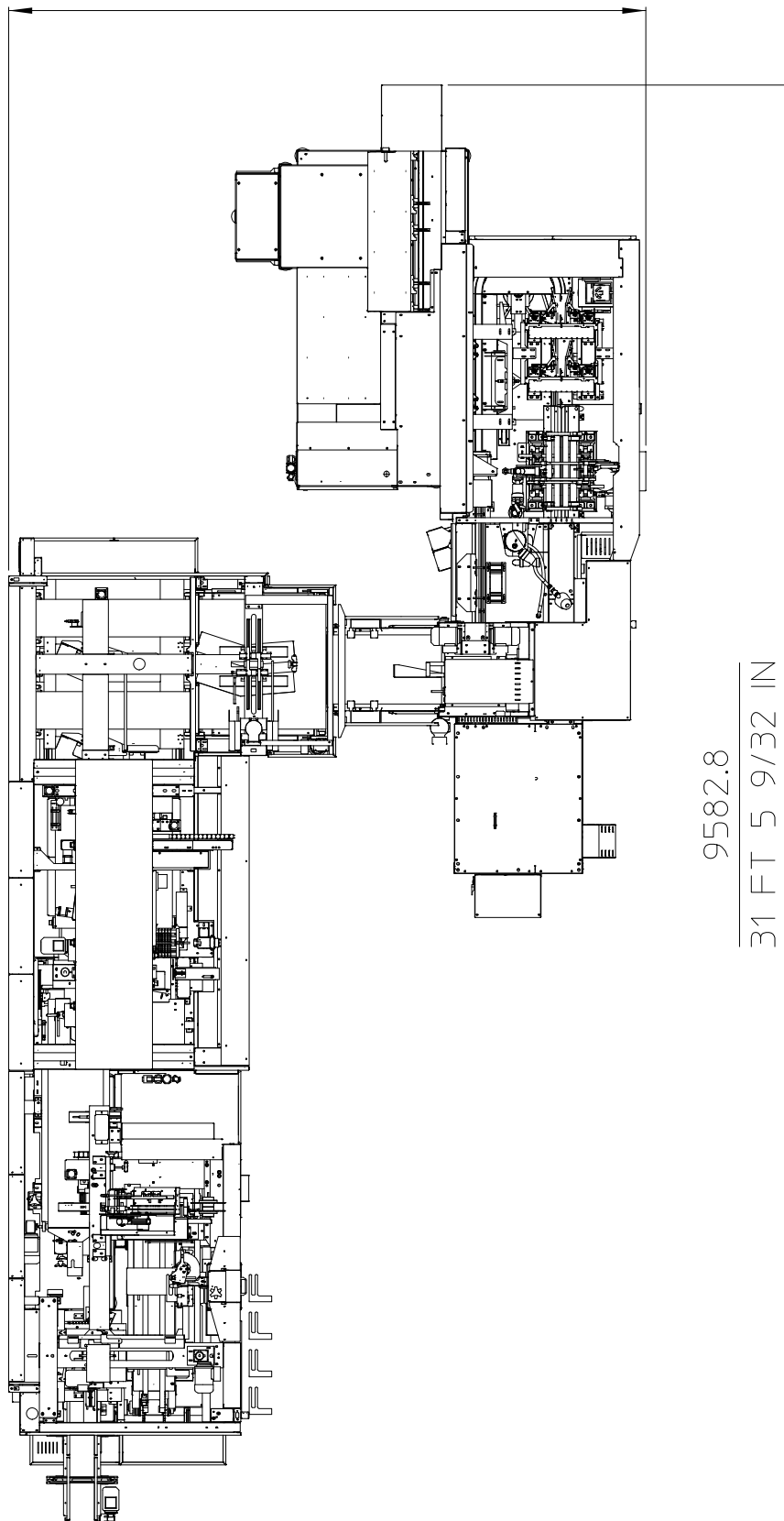

TECNOPEA



TECNOPEA S.R.L.

Via Don Eridano Torri, 2

25027 Quinzano d'Oglio, Brescia - Italy

Tel.: +39 030 992 3780 - Fax: +39 030 9923996

info@tecnopea.com - www.tecnopea.com